



**HUNTERS**  
RESIDENTIAL SALES AND LETTINGS

**Mays Lane, Barnet, EN5**

**Asking Price: £550,000**  
*Freehold*



# Mays Lane, Barnet, EN5

This redecorated extended three-bedroom family home offers generous living space and a 70ft south-facing rear garden.

The accommodation features a spacious front-aspect reception room, a separate fitted kitchen with an adjacent extended breakfast room, and a modern ground floor bathroom with a three-piece suite. Upstairs, there are three bedrooms and a separate WC.

Ideally situated just moments from St Catherine's RC Primary School, the property is within easy walking distance of High Barnet Underground Station (Northern Line, Zone 5), the High Street's wide range of shops, cafés, and restaurants, as well as the popular Saturday food market and The Spires Shopping Centre — home to Waitrose, H&M, and Anytime Fitness.

The area is well served by excellent local schools, including Queen Elizabeth's Boys' Grammar School, QE Girls' School, Ark Pioneer Academy, and Totteridge Academy.

- **EXTENDED FAMILY HOUSE**
- **THREE BEDROOMS**
- **RECEPTION ROOM**
- **KITCHEN**
- **BREAKFAST ROOM**
- **GROUND FLOOR BATHROOM**
- **60ft SOUTH FACING GARDEN**
- **CHAIN FREE**

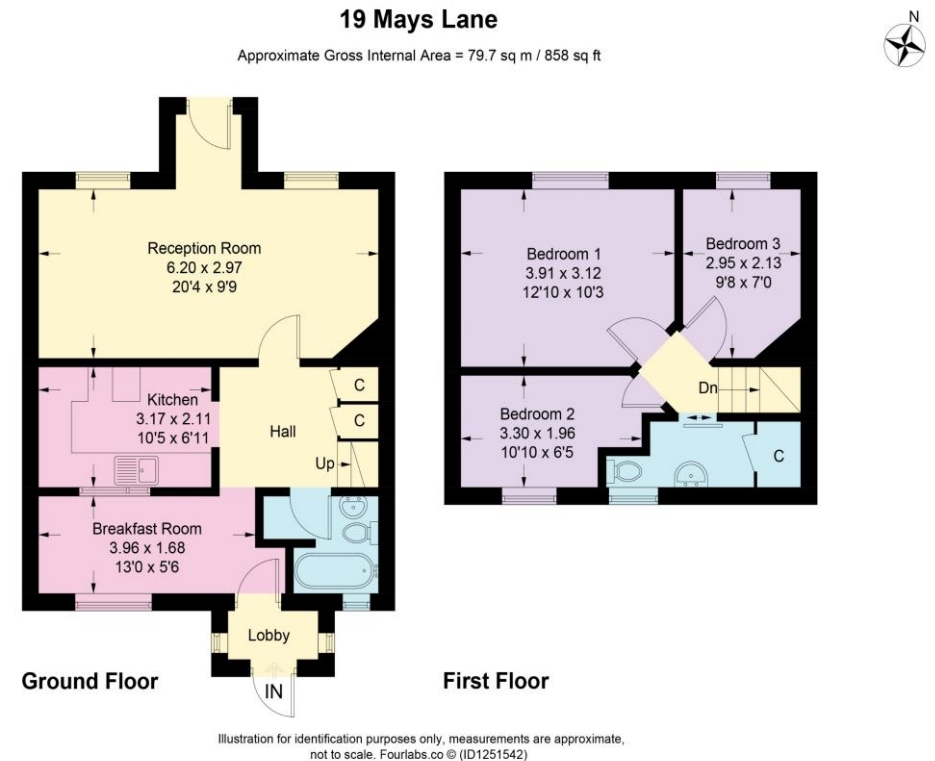



















Score	Energy rating	Current	Potential
92+	A		
81-91	B		88 B
69-80	C	71 C	
55-68	D		
39-54	E		
21-38	F		
1-20	G		

## Hunters Barnet

41 High Street  
High Barnet  
Barnet  
Hertfordshire  
EN5 5UW

T: 020 8441 3377 (sales) | 8441 6969 (lettings)

E: [info@hunters-barnet.co.uk](mailto:info@hunters-barnet.co.uk)

[www.hunters-barnet.co.uk](http://www.hunters-barnet.co.uk)

### Disclaimer

The agent has not checked any apparatus, fixtures or fittings or services and cannot verify they are in working order or fit for their purpose. Neither has the agent checked the legal documentation to verify the Freehold / Leasehold status of the property. Photographs are for illustration only and may depict items which are not for sale or included in the sale of the property.

Reference: **BRN250335**